



# Wire Guide

## **ASSEMBLY MANUAL**

v3.3 | January 2025



# CONTENTS

<b>SECTION A   TOOLS AND ADDITIONAL ITEMS REQUIRED</b>	<b>3</b>
TOOLS REQUIRED .....	3
<b>SECTION B   SYSTEM DETAILS</b>	<b>4</b>
OVERVIEW.....	4
<b>SECTION C   BOM &amp; DEDUCTIONS</b>	<b>5</b>
BOM - PARTS LIST .....	5
DEDUCTIONS.....	6
<b>SECTION D   PREPARATION</b>	<b>7</b>
FABRIC PREPARATION .....	7
<b>SECTION E   ASSEMBLY</b>	<b>8</b>
BOX 120 / BOX 160 .....	8
OPEN BRACKETS   78MM TUBE .....	10
CONTROL   MOTOR   78MM TUBE .....	11
CONTROL   CRANK   78MM TUBE .....	12
CONTROL   IDLER   78MM TUBE .....	12
FABRIC ASSEMBLY   78MM TUBE .....	12
BOX 160   110MM TUBE .....	13
BOX 190   S100 TUBES .....	13
OPEN BRACKETS   TOP/FACE FIX   S100 TUBES .....	15
OPEN BRACKETS   RECESS FIX   S100 TUBES .....	15
CONTROL   MOTOR   S100 TUBES .....	16
WEIGHT BAR ASSEMBLY .....	19
PREPARE & PACK FOR TRANSPORTATION .....	21
<b>SECTION F   APPENDIX A</b>	<b>22</b>
WIRE DEDUCTIONS .....	22
<b>SECTION G   DOCUMENT CHANGE NOTES</b>	<b>23</b>

## DISCLAIMER

### INTRODUCTION

This assembly manual for Wire Guide system has been produced by Rollease Acmeda to supply the necessary information for the safe and correct assembly of Wire Guide system.

### DISCLAIMER

Rollease Acmeda has used reasonable care in preparing the information included in this document, but makes no representations or warranties as to the completeness or accuracy of the information. Information is supplied upon the condition that the persons receiving the information will make their own determination as to its suitability for their purposes prior to use. Rollease Acmeda assumes no liability whatsoever for any damages incurred by you resulting from errors in or omissions from the information included herein. Rollease Acmeda reserves the right to make changes without further notice to any products to improve reliability, function or design.

### COPYRIGHT

COPYRIGHT © ROLLEASE ACMEDA

All rights are reserved. No part of this document may be reproduced or utilised in any means, by any means, electronic or mechanical including photocopying, recordings, or by any information storage or retrieval system, without the express permission from Rollease Acmeda.

**TOOLS REQUIRED**

**1** Circular Cutting Blade

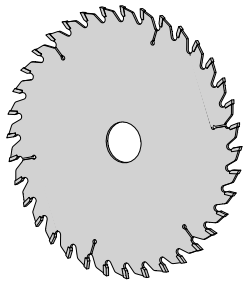

**2** Drill

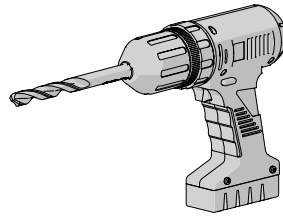

**3** Drill Bits

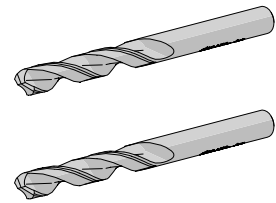

**4** Impulse Welder + Zip Welding Jig

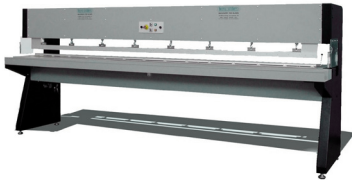

**5** Phillips Head Screwdriver

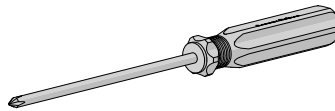

**6** Pliers

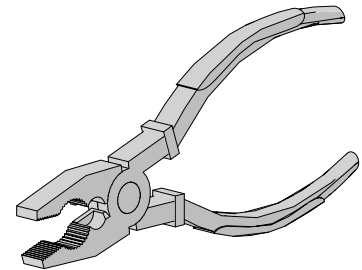

**7** Scissors



**8** Measuring Tape

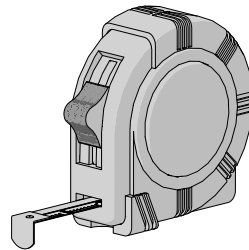

**9** Pencil

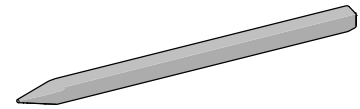

**10** Allen Key Set (Metric)

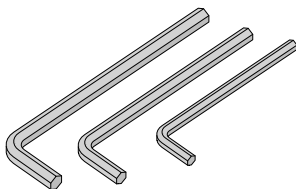

## OVERVIEW

### GENERAL SCHEMATIC

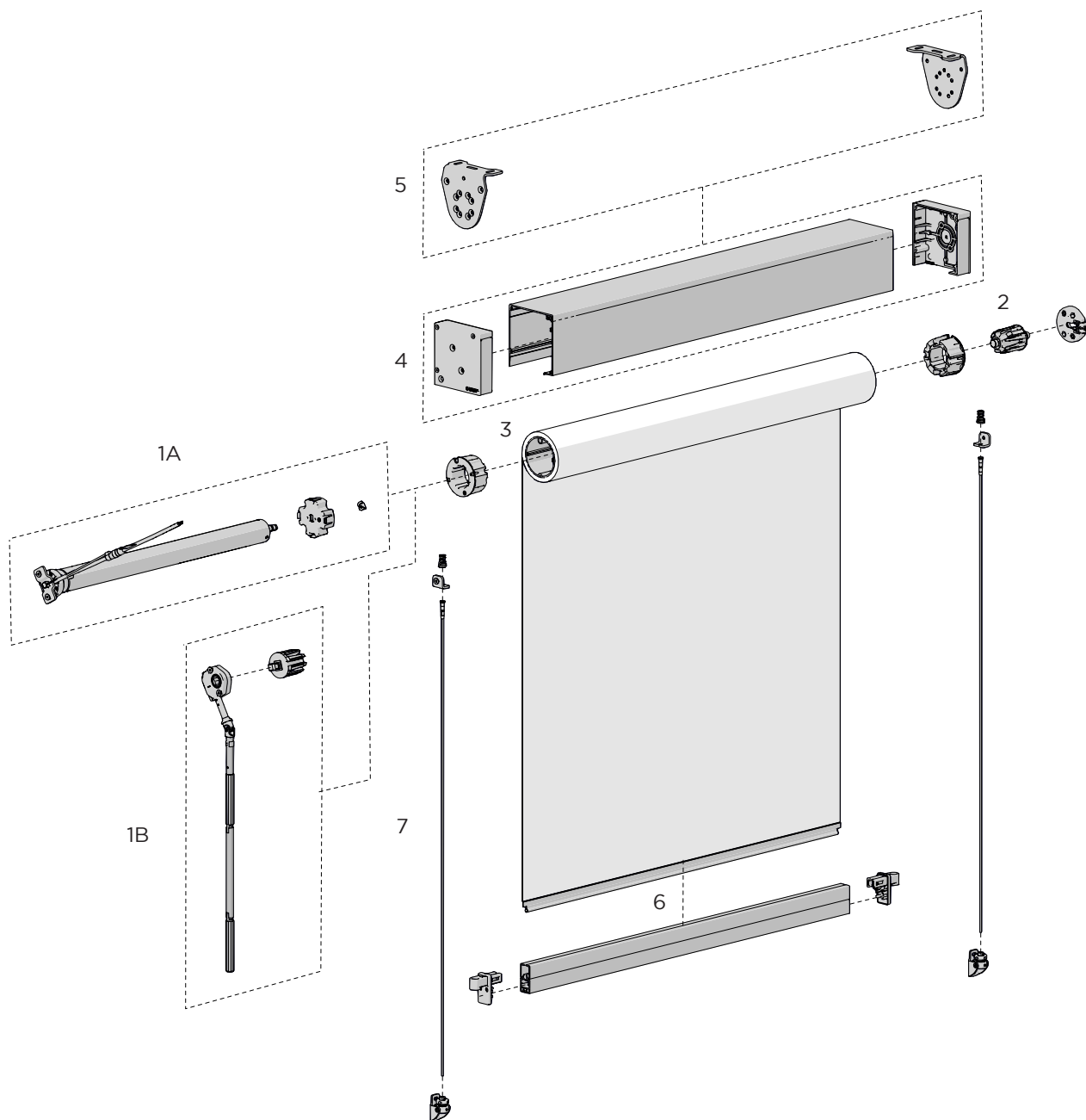

#### SYSTEM INDEX:

##### 1. CONTROLS:

- A - Motor
- B - Crank

##### 2. IDLER

3. **TUBE:** 78mm/110mm/130mm

4. **BOX:** 120/160/190

5. **BRACKETS:** Round/Extreme

6. **WEIGHT BAR:** F56/F72

7. **WIRE GUIDE:** 3.2mm/4mm

## BOM - PARTS LIST

	PART NUMBER	DESCRIPTION	U.O.M	QTY	
<b>BOX 120</b>	RE01-1101-xxx120	Box 120 End Plates	Set	1	
<b>BOX 160</b>	RE01-1106-xxx160	Box 160 - End Plate Set	Set	1	
<b>BOX 190</b>	RE01-1105-xxx001	Box 190 – End Plates & Screws Only	Set	1	
	RE01-1105-020100	Box 190 - Universal Bracket Extrusion (100mm)	Piece	2 / 3	
	RB80-1503-xxx110	Extreme Bracket Adaptor Kit (Motor & Idler Plate)	Set	1	
<b>OPEN</b>	RB80-1201-xxx109	Top / Face Fix Bracket Set   S100 Wire Guide	Set	1	
	RB80-0476-xxx100	Extreme Wire Guide Brkt. Adapter Kit	Kit	1	
	RB80-1503-xxx110	Extreme Bracket Adaptor Kit (Motor & Idler Plate)	Set	1	
	RE01-3020-xxx000	Open Brackets   ROUND   Mild Steel	Set	1	
	RE01-3021-xxx000	Open Brackets   ROUND   Stainless Steel			
	RE01-3030-xxx000	Open Brackets   SQUARE   Mild Steel	Set	1	
RE01-3031-xxx000	Open Brackets   SQUARE   Stainless Steel				
<b>WIRE GUIDE 3.2mm</b>	RE24-4004-010032	Wire Guide Top Saddle Terminal Kit w/ Spring	Set	2	
	RE24-2205-xxx000	Bottom Wire Guide Swivel Bracket - Floor/Face Fix	Piece	2	
	RE24-1312-010032	Wire Rope - 3.2mm (1x19)   50m Rolls	Roll	1	
	RE24-1312-009902	Dome Head Terminal for 3.2mm Wire	Piece	2	
	RE24-1312-009420	Swaged Dome Stud Terminal + 4.2m Wire Rope	mm (in)	2	
<b>WIRE GUIDE 4mm</b>	RB91-3602-006041	Wire Guide Tensioning Cable w/ Clear PVC Coating   4mm (7x7)	mm (in)	2	
	RB80-0481-012000	Box 190 Wire Guide Adaptor Plate with Screws	Set	2	
	RE24-1314-009400	Machined Fork Swage Terminal for 4mm S/Steel Wire	Set	2	
	RE24-2601-009040	Tensioning Bracket & Stud Terminal for 4mm S/Steel Wire	Set	2	
	RE24-1401-009040	Threaded Stud Terminal + Nut + Washer for 4mm S/Steel Wire			
	RE24-9101-009050	Spring for Threaded Stud Terminal	Set	2	
	RE24-2301-009090	Wall Mounting Bracket LH & RH set – 90mm x 38mm	Set	1	
<b>GEAR</b>	RE01-0513-xxx003	Gear 5:1 [7.5Nm] + Screws	Set		
	RE01-0517-xxx003	Gear 8:1 [20Nm] + Screws			
	RE01-0510-020000	RE01 Gear   Universal Joint	Piece	1	
	RE01-0502-050045	Crank Adaptor   45mm	Piece	1	
	RB05-9102-xxx000	Gear/Crank Operation Arm Support	Piece	1	
	RB05-9101-xxxLLL	Gear/Crank Operation Control Arm - 100 / 150 / 200 cm	Piece	1	
<b>MOTOR</b>	MT01-1145-050001	AUTOMATE   ARC FT Motor   [Ø45/15Nm/15rpm] (AU)	Unit	1	
	MT01-1145-050012	AUTOMATE   ARC FT Motor Long Conn.   [Ø45/15Nm/15rpm] (AU)			
	MT01-1145-069003	AUTOMATE   ARC FT SLIM Motor   [Ø45/15Nm/32rpm] (US)			
	MT01-1145-0690xx	AUTOMATE   ARC AX30 Motor (Refer catalogue for Part #'s)			
	MT01-1145-0690xx	AUTOMATE   ARC AX50 Motor (Refer catalogue for Part #'s)			
		Refer Catalogue.	AUTOMATE   Remotes, Sensors or Accessories	-	-
	RE01-0603-025000	AUTOMATE   45mm SLIM MOTOR 10mm Sq. Shaft (US)	Set	1	
	RE01-0601-025000	AUTOMATE   45mm Motor Bracket Adaptor + Screws (US)	Set	1	
	MT03-0106-050006	AUTOMATE   78mm Drive Wheel - Single Piece	Piece	1	
	MT03-0106-050005	AUTOMATE   Crown 45mm to 78mm Tube w/ Screws	Piece	1	
	MTCLIP-35-45	Motor Drive Clip for 35/45mm Motors (US)	Piece	1	
	RB56-0762-014050	Zamak Adaptor with Lock Ring & Screws	Set	1	
	RB80-0301-073100	S100 - Universal Drive Wheel	Unit	1	
RB80-0701-073100	S100 - Universal Motor Crown	Unit	1		
MT03-0198-025008	AUTOMATE   30Nm/50Nm Extreme Drive Shaft Adaptor	Set	1		
<b>IDLER</b>	RE01-0214-050000	Idler/Spring Adaptor MKII + Screws	Set	1	
	RE01-0215-050000	Box 160 - Extreme Idler Adaptor w/ Screws	Set	1	
	RB80-0202-073100	EXTREME Bearing Idler   Universal   S100	Unit	1	
	RE01-0213-050045	Bearing Idler   45mm	Piece	1	
<b>WEIGHT BAR OPTIONS</b>	RE15-0601-xxx001	F56 Wire Guide Weight Bar End Cap Set	Set	1	
	RE15-0522-xxx000	F72 Multi-Bar End Caps   Wire Guide (w/ screws)	Set	1	
	SB91-0001-050580	Weight Bar Bubble Seal Strip 8 x 12mm x 5.8 metre	mm (in)	1	
	RE91-1101-050025	F56   25mm Strap Down Loop (Plastic)	Set	2 +	
	RE91-1101-013025	25mm Footmans Loop (Metal)	Set	2 +	
	RE91-0100-025025	25mm Cam Buckle & Strap Assembly	Set	2 +	
	RE91-1104-013030	Strap Down Pad Eye Saddle - 30mm	Set	2 +	
<b>TUBE PARTS</b>	RB80-0601-073110	S100 - STD Roller End Plate Pair - 110mm	Set	1	
	RB80-0601-073130	S100 - STD Roller End Plate Pair - 130mm			
	RB80-0601-073160	S100 - STD Roller End Plate Pair - 160mm			

DEDUCTIONS

PART NUMBER	DESCRIPTION	U.O.M	QTY	WIRE GUIDE							
				78mm OPEN	BOX 120	BOX 160 & 3.2mm WIRE GUIDE		BOX 190	S100 OPEN		
						78mm	110mm		TOP / FACE FIX BRACKETS	RECESS FIX BRACKETS	
BOX 120	RE01-0101-xxxxLL	Box 120 Back	mm (in)	1							
	RE01-0102-xxxxLL	Box 120 Front Cover	mm (in)	1		W - 66 (2.60)					
	RE01-0103-xxxxLL	Box 120 Semi Cover	mm (in)	1							
BOX 160	RE01-0111-xxxxLL	Box 160 - Top/Back Cover	mm (in)	1				W - 66 (2.60)			
	RE01-0113-xxxxLL	Box 160 - Front Cover w/ Bubble	mm (in)	1				W - 8 (0.32)			
	SB91-0022-050400	Fabric Brush - T-Slot 13mm x 4.8mm	mm (in)	2					W + 176 (6.93)		
BOX 190	SB91-0012-050300	Fabric Brush - T-Slot - 10mm High	mm (in)	2							
	RE01-0106-xxxxLL	Box 190 Universal Extrusion (Top & Back)	mm (in)	2							
	RE01-0107-xxxxLL	Box 190 Front Cover	mm (in)	1					W - 24 (0.94)		
	SB91-0516-050009	Foam Tape	mm (in)	2							
WEIGHT BAR OPTIONS	RE15-0101-xxxxLL	F56 HD Weight Bar	mm (in)	1		W - 92 (3.62)					
	RE15-0112-xxxxLL	F72 Multi-Bar	mm (in)	1			W - 92 (3.62)		W - 120 (4.72)	W - 115 (4.53)	
	SB91-0408-001015	7.2mm PVC Spline with 15mm tail   100m roll	mm (in)	1		W - 92 (3.62)				W - 96 (3.78)	
	SB91-0409-050015	7mm Fabric Spline with 15mm tail   100m roll	mm (in)	1			W - 92 (3.62)		W - 120 (4.72)	W - 115 (4.53)	
	SB91-0019-050580	16mm Bubble Seal   F56   5.8 metre lengths	mm (in)	1				W - 92 (3.62)			
	SB91-0008-050050	Ultra-Lock Seal V3	mm (in)	1							
	SB91-0018-050040	16mm Bubble Seal   F72   40 Lm Rolls	mm (in)	1							
	SB91-0013-050150	8mm Bubble Seal Push Fit   150 Lm Roll	mm (in)	1							
	SB91-1015-050200	F56 - 20 x 5mm Ballast x 2m (0.8kg/m)   Wrapped	mm (in)	0 - 4		W - 92 (3.62)					
	SB91-1018-050200	F72 - 25 x 8mm Ballast x 2m (1.6kg/m)   Wrapped	mm (in)	0 - 4			W - 92 (3.62)		W - 120 (4.72)	W - 115 (4.53)	
TUBE PARTS	RE01-0377-0001LL	78mm STD V2 AL Tube w/ screw features									
	RE01-0380-0001LL	78mm HD V2 AL Tube w/ screw features				W - 68 (2.68)		W - 68 (2.68)			
	AW92-0901-0001LL	78mm Steel Tube									
	RB93-0110-xxxxLL	S100 - 110mm AL Tube	mm (in)	1				W - 90 (3.54)		W - 110 (4.33)	
	RB93-0130-xxxxLL	S100 - 130mm AL Tube	mm (in)	1						W - 115 (4.53)	
	RB93-0160-xxxxLL	S100 - 160mm AL Tube	mm (in)	1						W - 96 (3.78)	
	SB91-0130-xxxxLL	S100 - 130mm AL Tube (Sleeves Motor & Idler in 160mm)							Refer manuals for cut length.		
	SH91-0135-050200	Zip No. 6 Gauge, Double Sided (for 78 AL Tube ONLY)	mm (in)	1							
	SB91-0408-001015	7.2mm PVC Spline w/ 15mm Tail   100m roll	mm (in)	1		W - 92 (3.62)		W - 92 (3.62)			
	SB91-0409-050015	7mm Fabric Spline w/ 15mm Tail   100m roll	mm (in)	1				W - 120 (4.72)	W - 115 (4.53)	W - 96 (3.78)	
FABRIC	NOT SUPPLIED	Fabric Width	mm (in)	1		W - 92 (3.62)		W - 92 (3.62)	W - 120 (4.72)	W - 115 (4.53)	W - 96 (3.78)
		Fabric Drop	mm (in)	1				78mm Tube: D + 250 (9.84) 110mm Tube: D + 350 (14.57) 130mm Tube: D + 430 (16.93) 160mm Tube: D + 525 (20.67)			

## FABRIC PREPARATION

## 1 Cut fabric to size

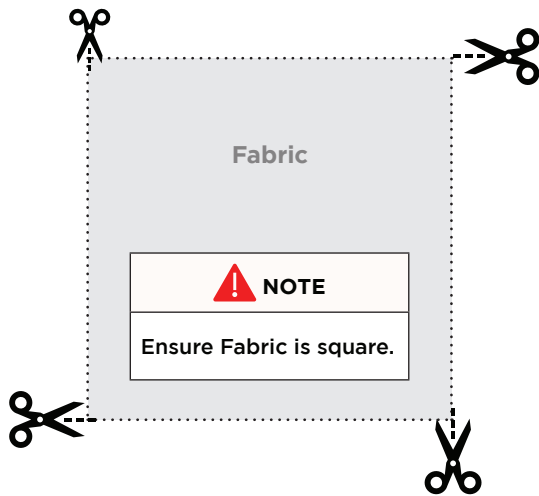

## 💡 FABRIC TIPS:

Some fabric types should be used with caution as the weld quality can be problematic. Consult your fabric supplier for the recommended welding requirements of the following materials:

- Clear PVC
- Metallic backed
- Rubberised / foam backed
- Heavily textured / patterned
- Fabrics with bonding tapes (as fabric does not contain a plasticiser).

## 2 Weld fabric Spline to top &amp; bottom edges

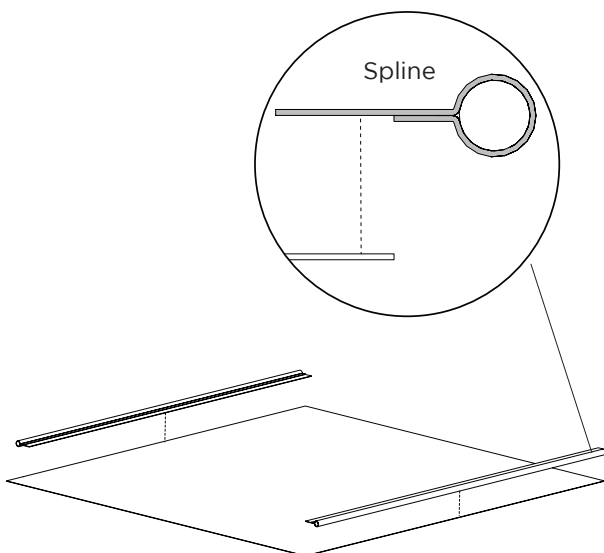

## 💡 WELDING TIPS

- Ensure welding area and fabric is clean and free from dust and dirt. If dust and dirt is evident this will lead to sparking and burning of the fabric.
- Before welding your fabric, undertake weld testing on scrap pieces.
- If the temperature / amperage on the welding machine is too low, the weld will not bond the fabric properly, this is referred to as a 'cold weld'.
- If the temperature / amperage on the welding machine is too high, the fabric will burn.
- When using a High Frequency Welding Machine, ensure the welding overlap is at least 50mm. If the overlap is any shorter than this a 'cold weld' may occur at this area.
- For fabrics with a higher content of plastic in them, a higher-level sheen will be evident. When using a High Frequency Welding Machine and the fabric is overlapped to achieve a quality weld, the level of sheen on the fabric at this area will be reduced.

**BOX 120 / BOX 160**

- 1** 1a. Remove ears from end plates on each side.  
 1b. Drill 6mm hole in each end plate for wire guide terminals.

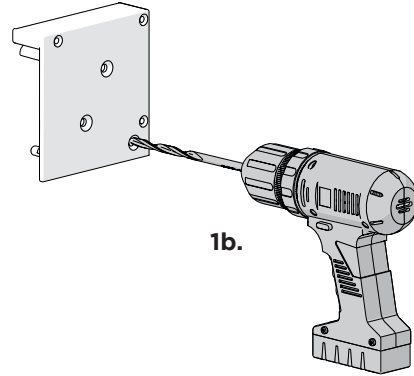
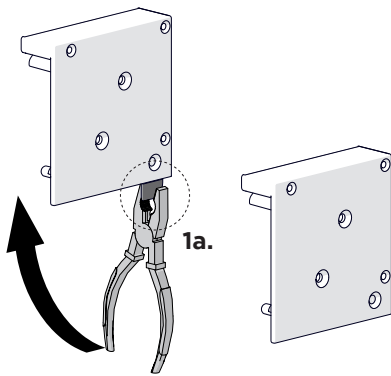

- 2** Remove end plate cover leg  
 This is only required:
- At one end when using a crank control.
  - At both ends when using the Box 120 Semi Front Cover.

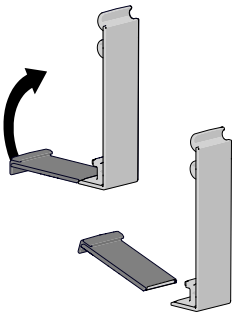

**NOTE**

It is advised that pliers are used to remove break-off & to clean the break with a file.

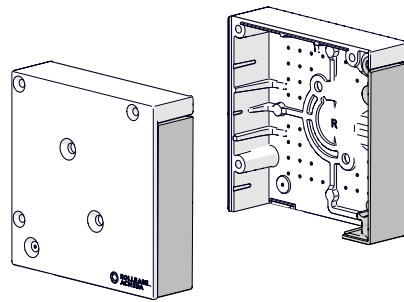

- 3** Attach control & Idler hardware

MOTOR CONTROL

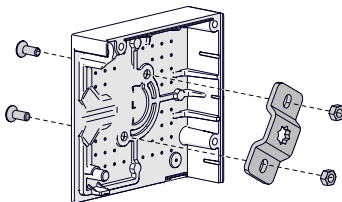

CRANK CONTROL

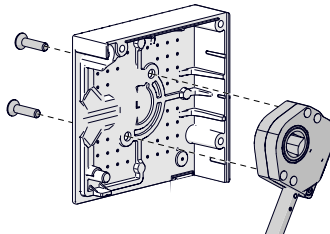

IDLER ADAPTOR

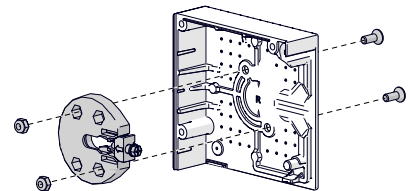

**NOTE**

Install Retainer Clip in bracket adaptor so it doesn't get lost in transport.



**BOX 120 / BOX 160****4** (Only for Box 160)

4a. Insert brushes into the front and back covers.

4b. Ensure bubble seal is installed in Box 160 Front Cover.

The bubble seal is supplied assembled on powder coated extrusion, or loose for mill finish.  
The bubble seal may be cut into separate pieces for ease of assembly.

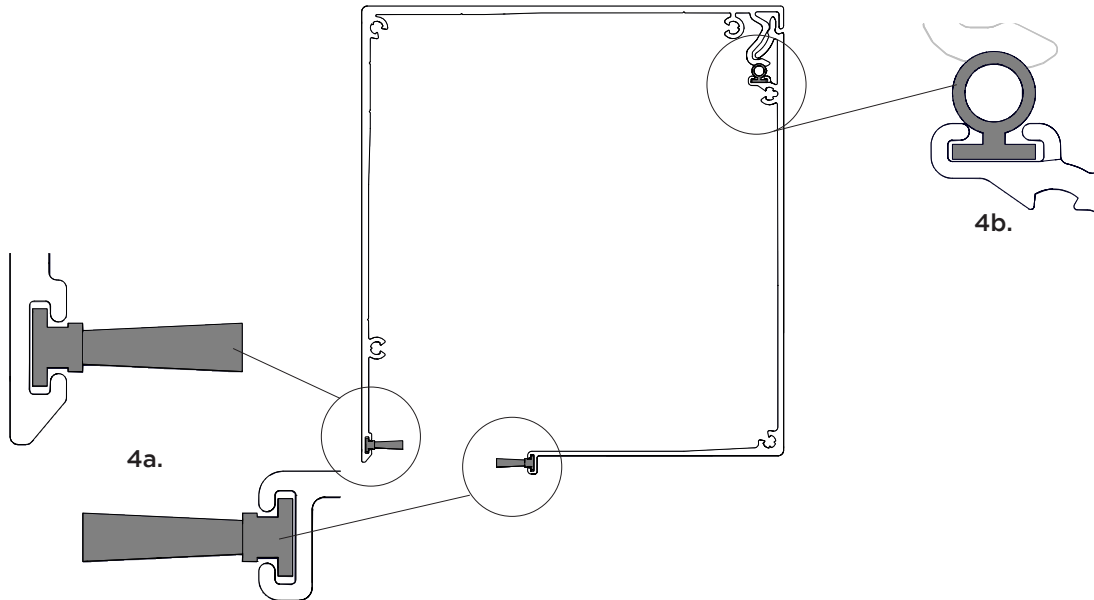
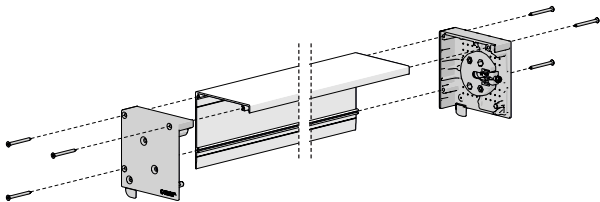
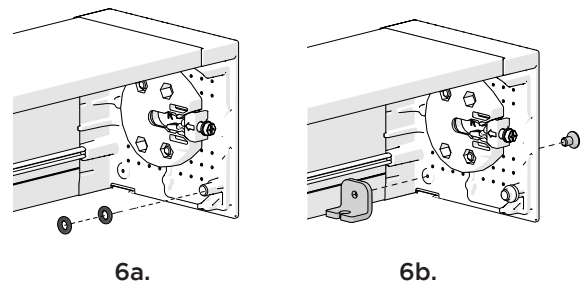
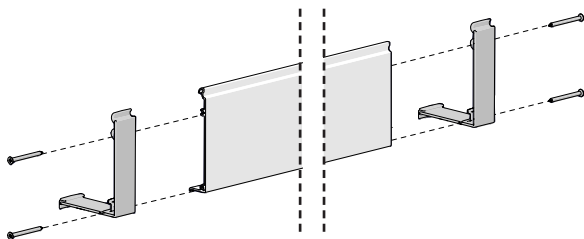
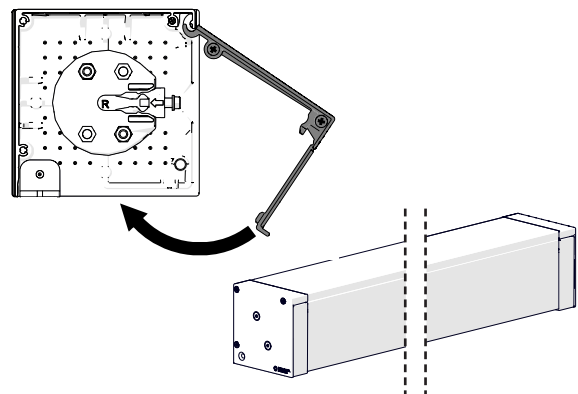
**5** Attach end plates to box**6** 6a. Attach 2x o-rings to each side.  
6b. Attach wire guide terminals on each side.**7** Attach front cover end plates**8** Attach front cover assembly to box assembly

## OPEN BRACKETS | 78MM TUBE

**1** Attach control hardware

MOTOR CONTROL

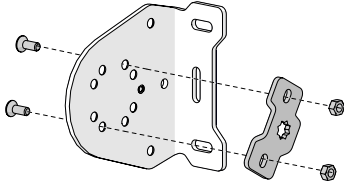

GEAR CONTROL

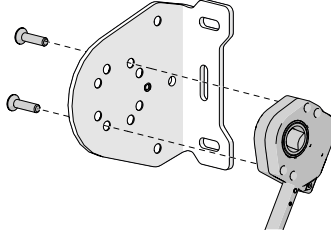

**2** Attach Idler hardware

IDLER ADAPTOR

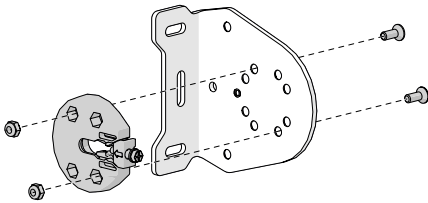

**!** NOTE

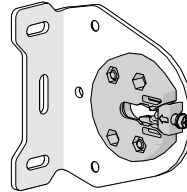

Ensure Idler opening is horizontal to installation orientation.

**3** Attach Wire Guide Terminals on each side

FACE FIX

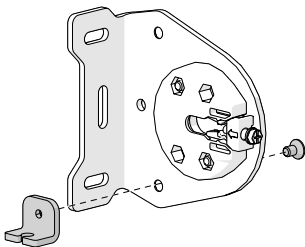

TOP FIX

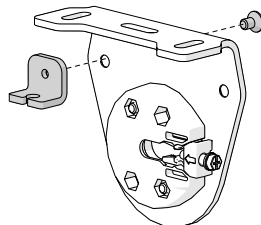

**CONTROL | MOTOR | 78MM TUBE**

**1** Assemble crown, drive and clip

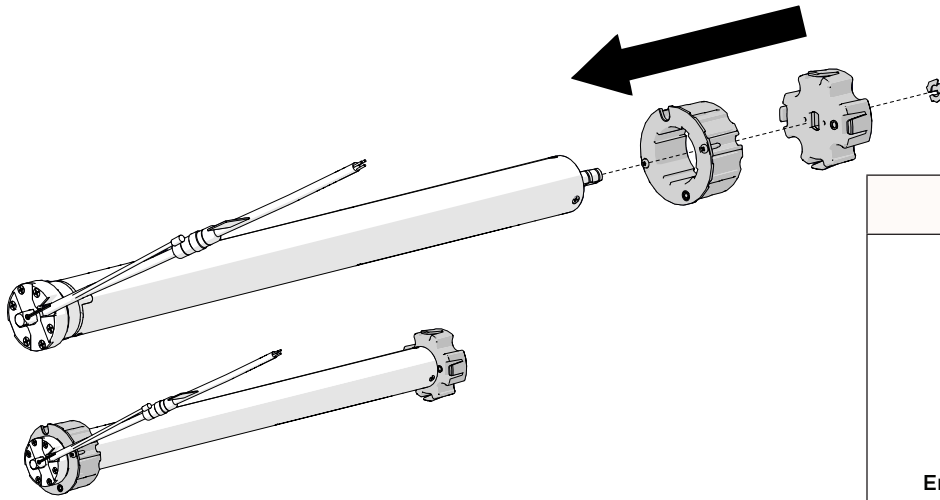

**NOTE**

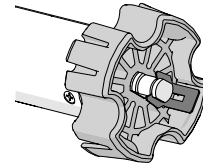

Ensure the clip is attached correctly with the drive shaft

**2** Insert motor in tube and fasten crown in place

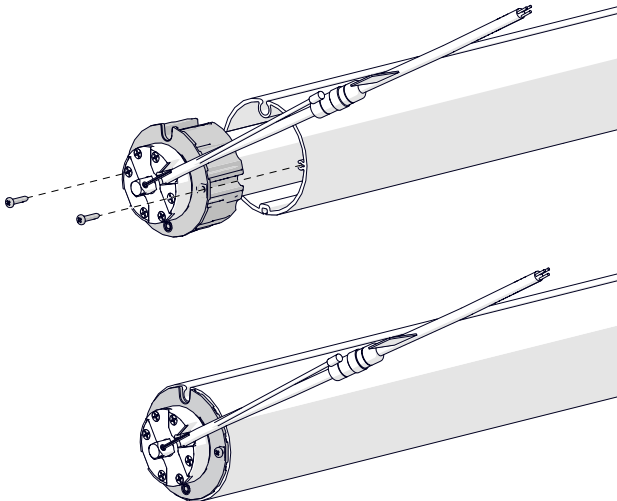

**CONTROL | CRANK | 78MM TUBE**

- 1** a. Insert crown into tube and fasten into place.  
b. Insert crank adaptor into crown until it locks into place.

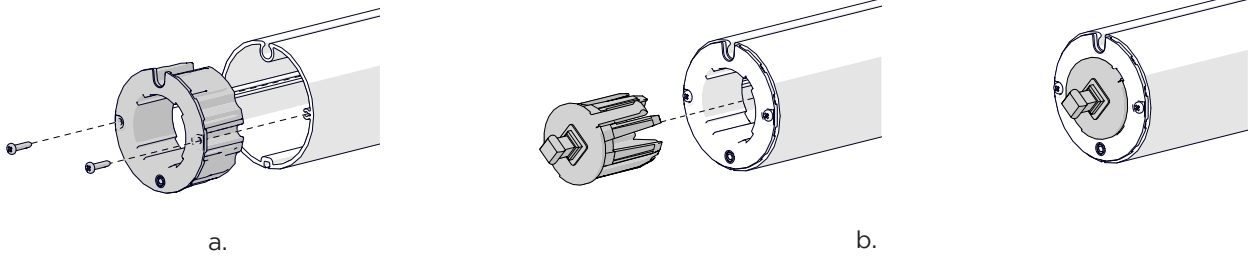

- 2** a. Insert uni-joint into crank handle.  
b. Insert c-clip pin through shaft hole to secure uni-joint.

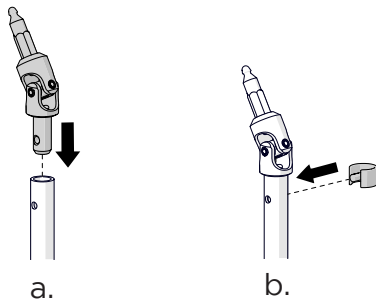
**CONTROL | IDLER | 78MM TUBE**

- 1** a. Insert crown into tube and fasten into place.  
b. Insert idler into crown until it locks into place.

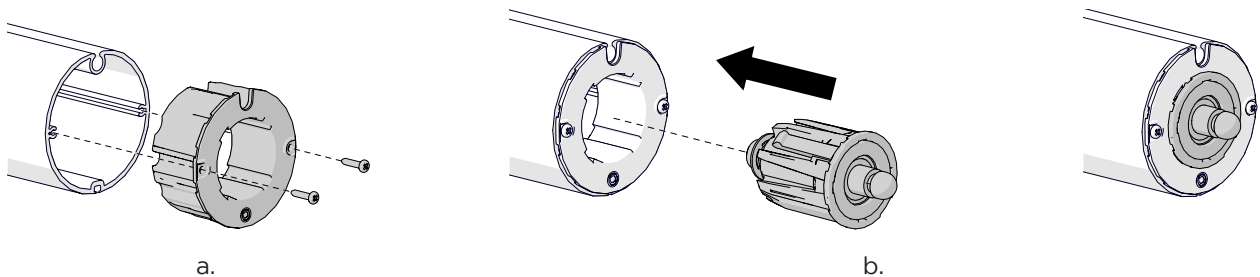
**FABRIC ASSEMBLY | 78MM TUBE**

- 1** Insert fabric into tube

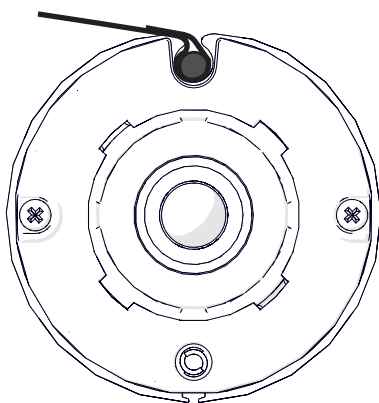

- 2** Roll fabric around tube

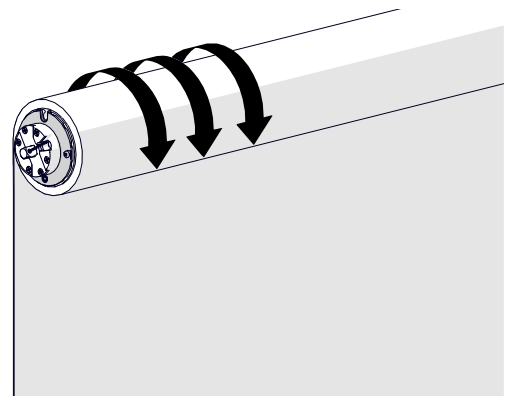

## BOX 160 | 110MM TUBE

**1** Attach control hardware

MOTOR CONTROL

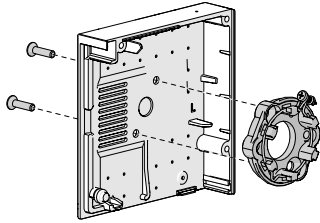

**2** Attach Idler hardware

IDLER ADAPTOR

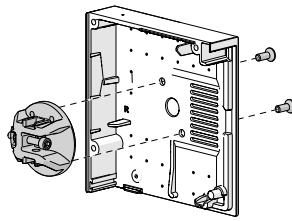

**NOTE**

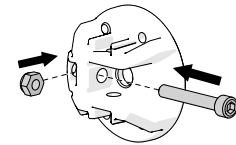

Assemble fasteners in idler adaptor so it doesn't get lost in transport.

## BOX 190 | S100 TUBES

**1** Attach control hardware

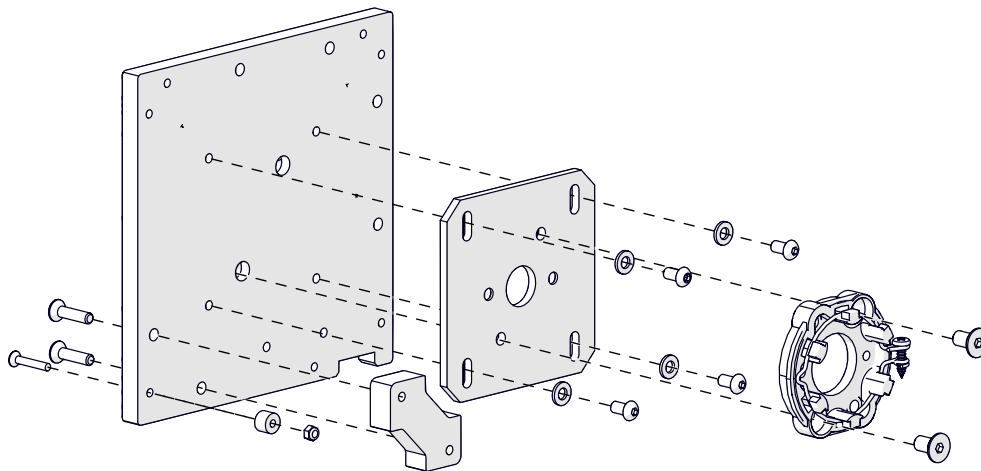

**2** Attach idler hardware

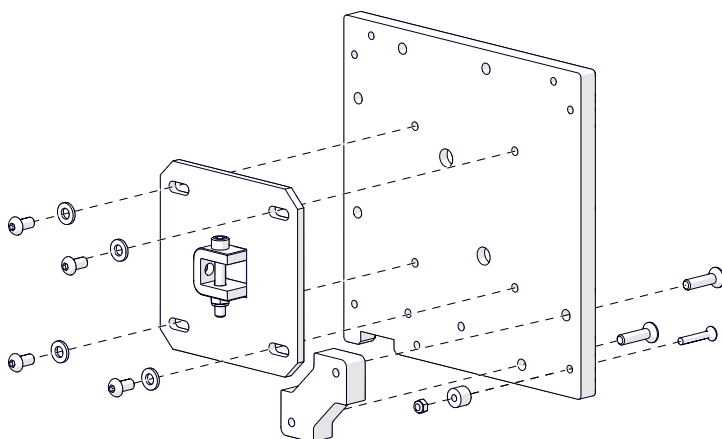

**NOTE**

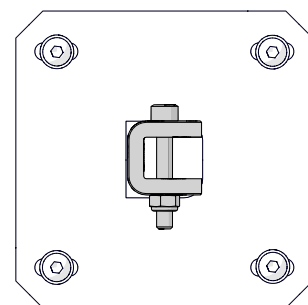

Ensure 'U' shaped saddle is orientated correctly.

## BOX 190 | S100 TUBES

## 1 Assemble top &amp; back cassette extrusions

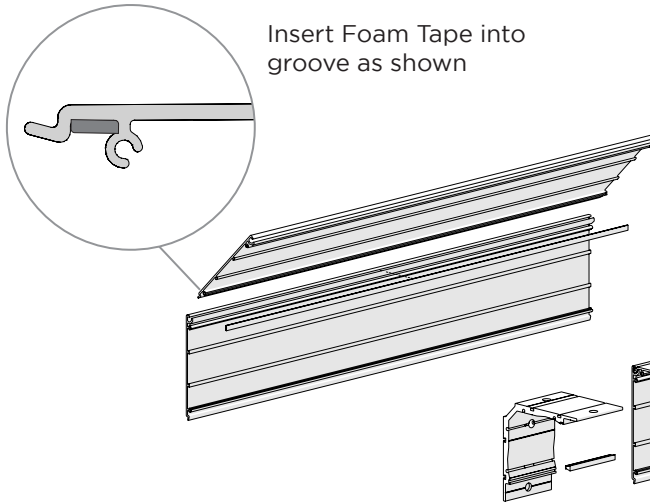

## NOTE

- Assemble with additional Universal Bracket Extrusion for systems wider than 4m [158"].
- Cut brush to 100mm [4"] lengths to fit brackets.

## 2 Attach end plates to cassette assembly

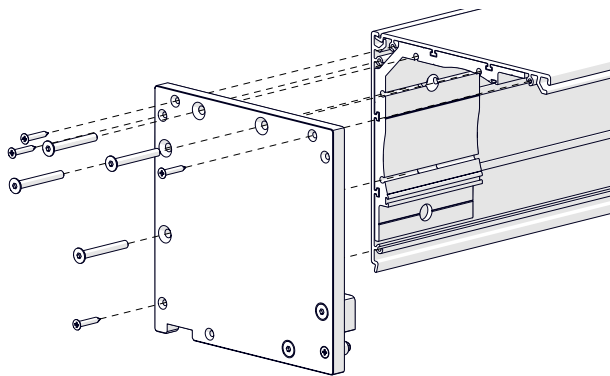

## 3 Attach Wire Guide Adaptor Plate on each side

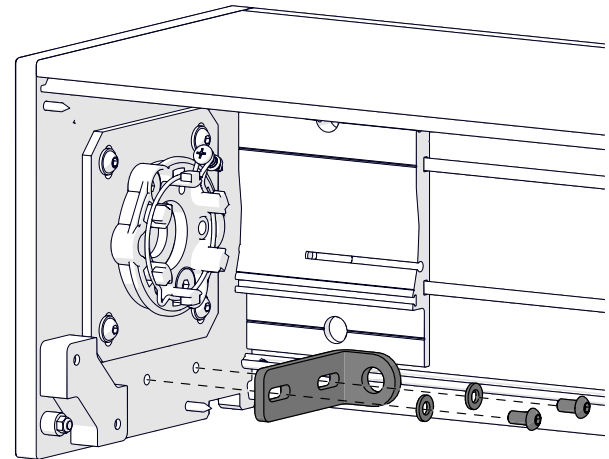

## 4 Assemble Foam Tape in top joint, and brush in bottom feature

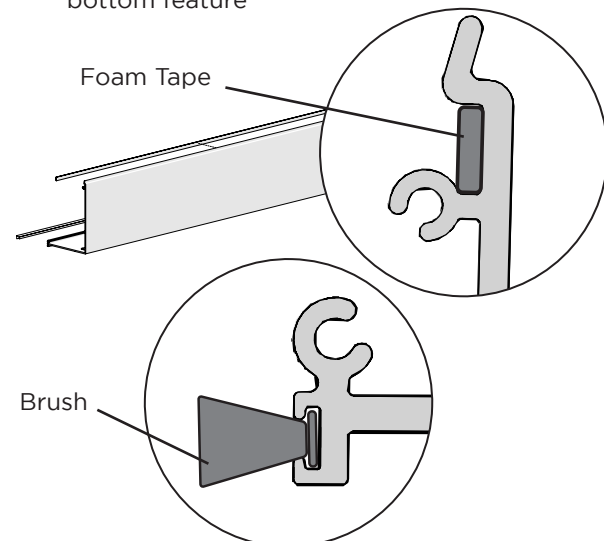

## 5 Attach front cover assembly to box assembly

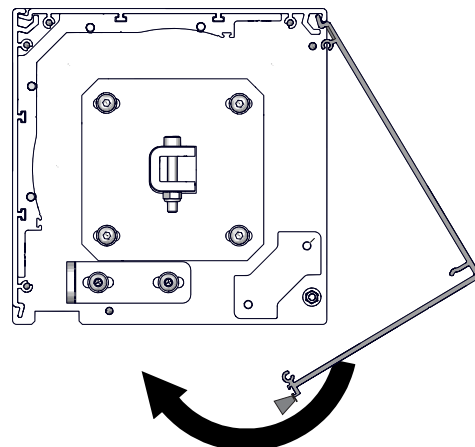

## OPEN BRACKETS | TOP/FACE FIX | S100 TUBES

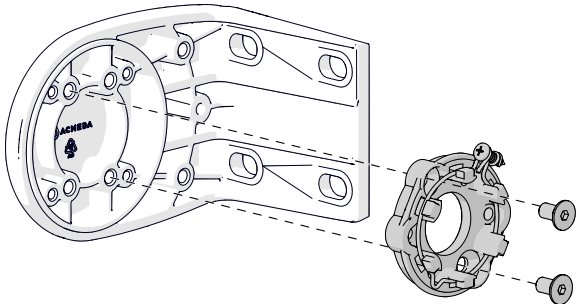
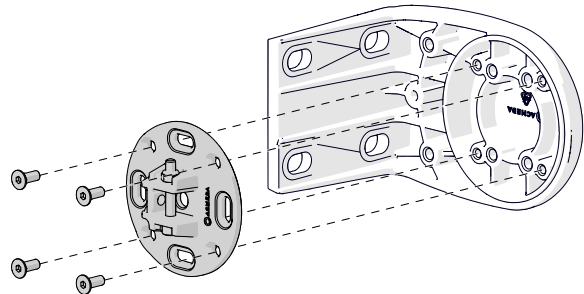
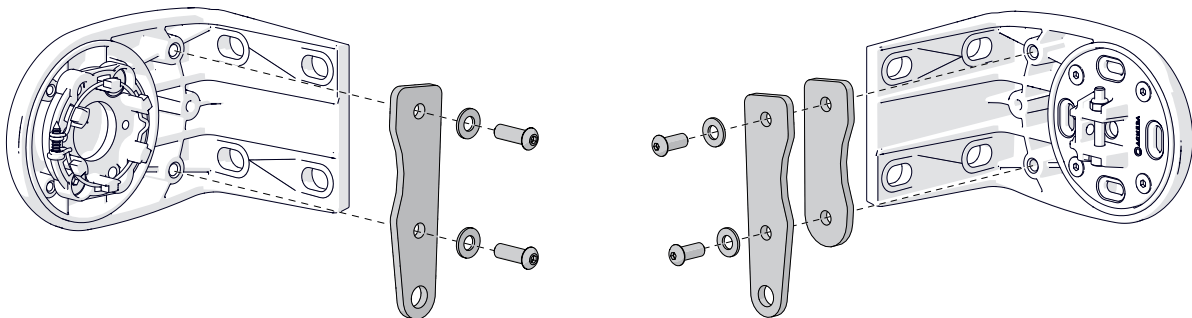
**1** Attach control hardware**2** Attach Idler hardware**3** Assemble wire guide adaptors to brackets

## OPEN BRACKETS | RECESS FIX | S100 TUBES

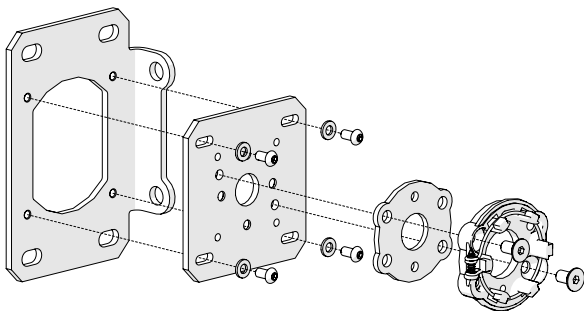
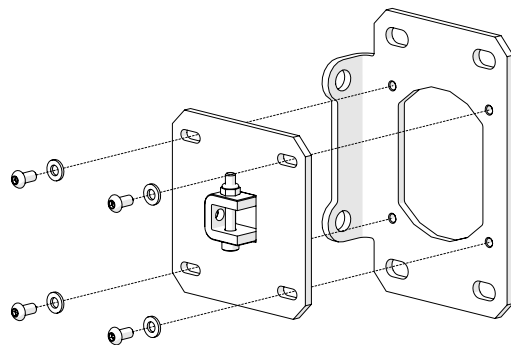
**1** Attach control hardware**2** Attach control hardware

**CONTROL | MOTOR | S100 TUBES**

- 1 Assemble motor with crown, drive & adaptor kit

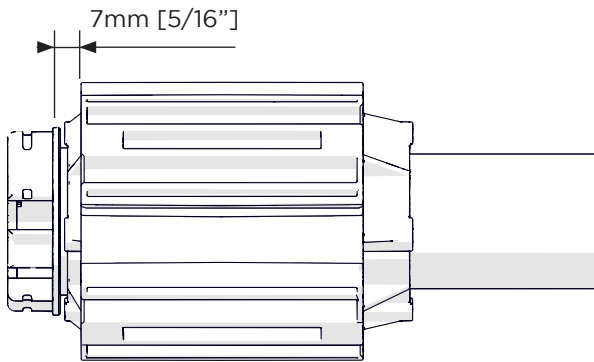
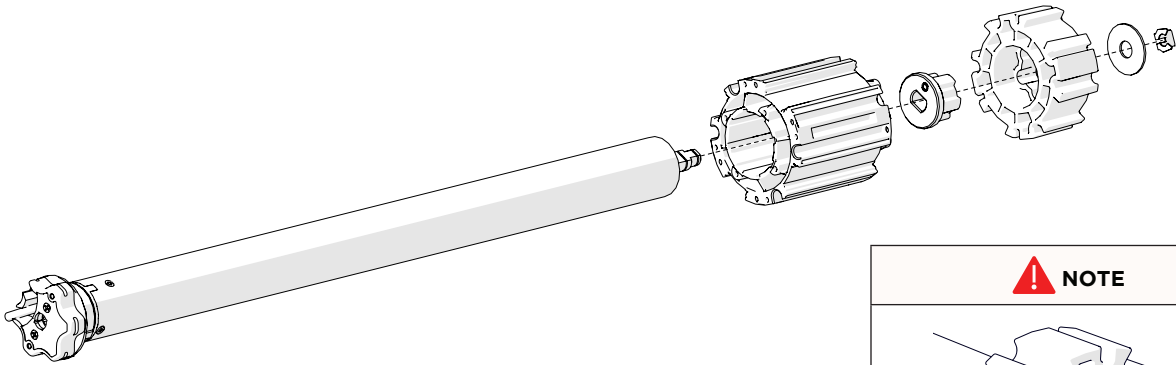

**NOTE**

Ensure the clip is attached correctly with the drive shaft

**NOTE**

Ensure crown is installed in the correct orientation for Wire Guide

**VISUAL CHECK**

- ☑ If using an AX Motor, ensure the crown is orientated correctly as shown below:

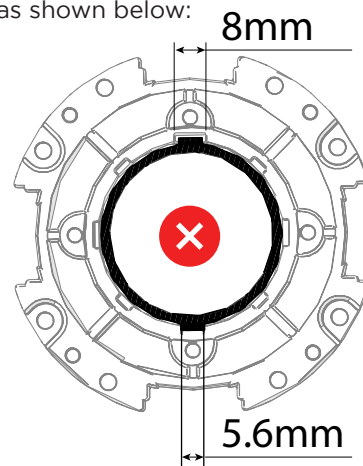
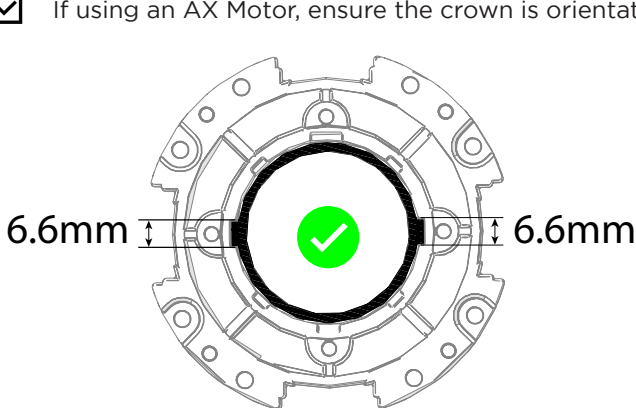



**CONTROL | MOTOR | S100 TUBES**

- 1 Insert motor assembly into tube & fasten end plate in place

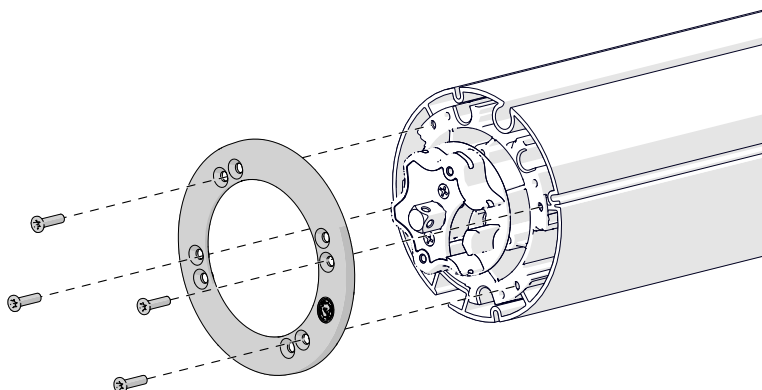

- 2 Secure drive wheel to tube with counter sunk screw

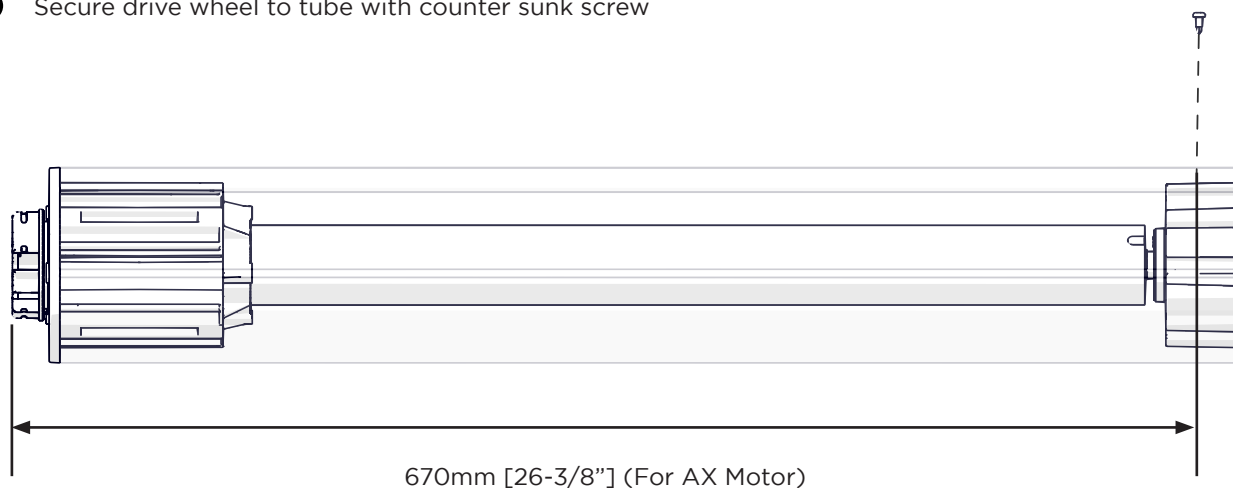

HOLE = Ø4.5mm (0.18")

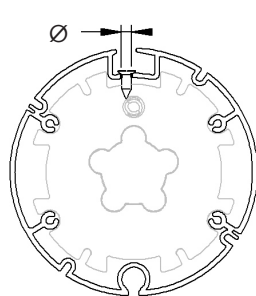

110mm

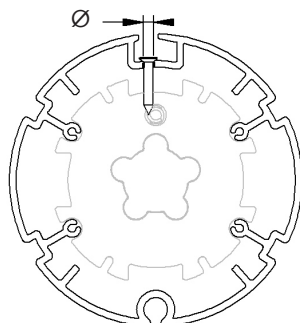

130mm

TUBE	SCREW
110mm	#8 x 1/2"
130mm	#8 x 1" Screw

## FABRIC ASSEMBLY | S100 TUBES

- 1 Insert fabric into tube

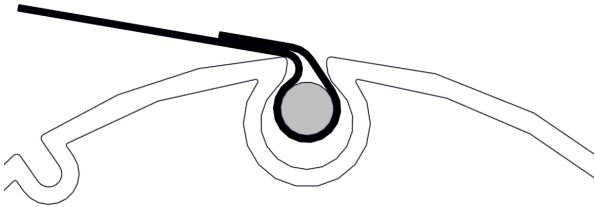

- 2 Insert idler into tube, ensure correct idler orientation

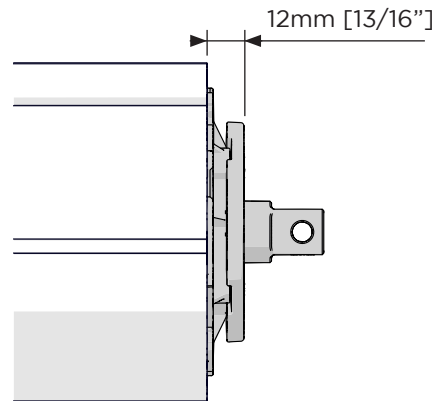

- 3 Fasten end plate in place

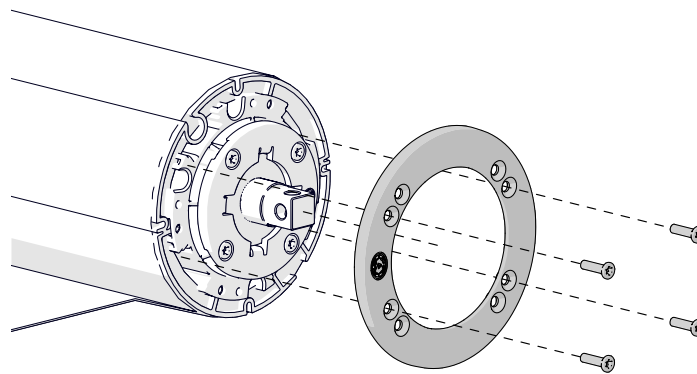

- 4 Roll fabric around tube

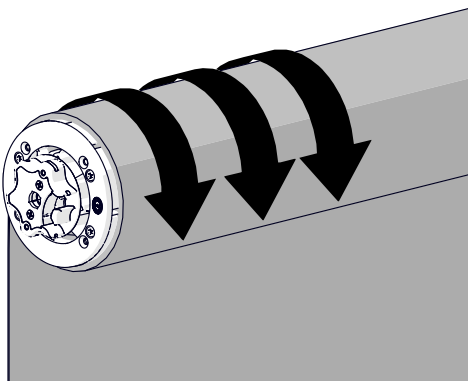

## WEIGHT BAR ASSEMBLY

- 1** Slide weight bar onto fabric

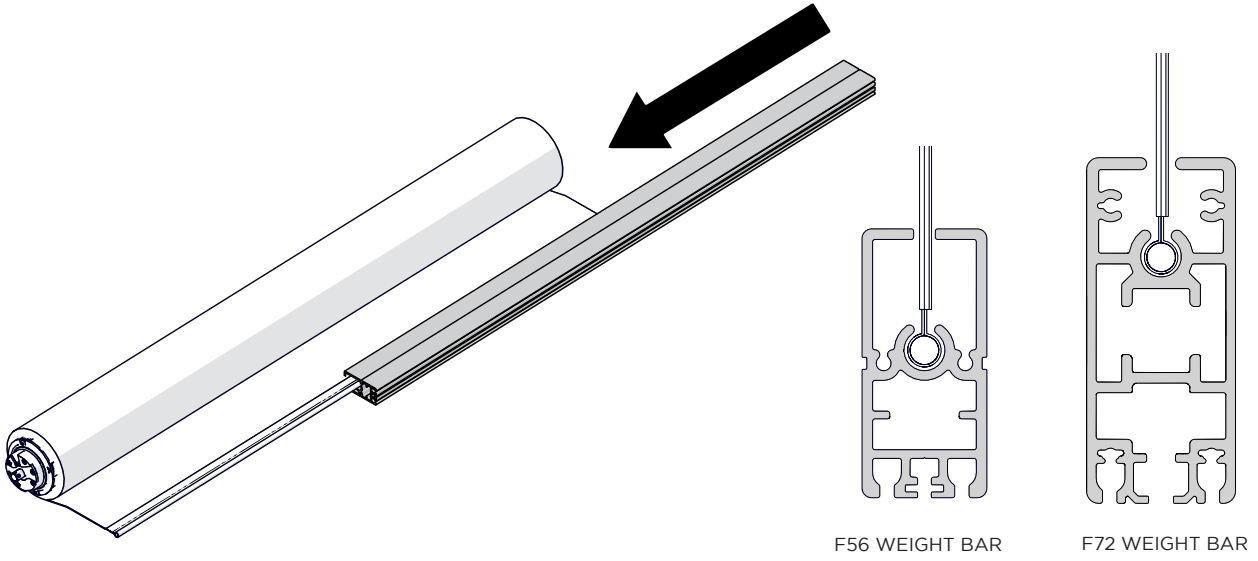

- 2** Insert end caps

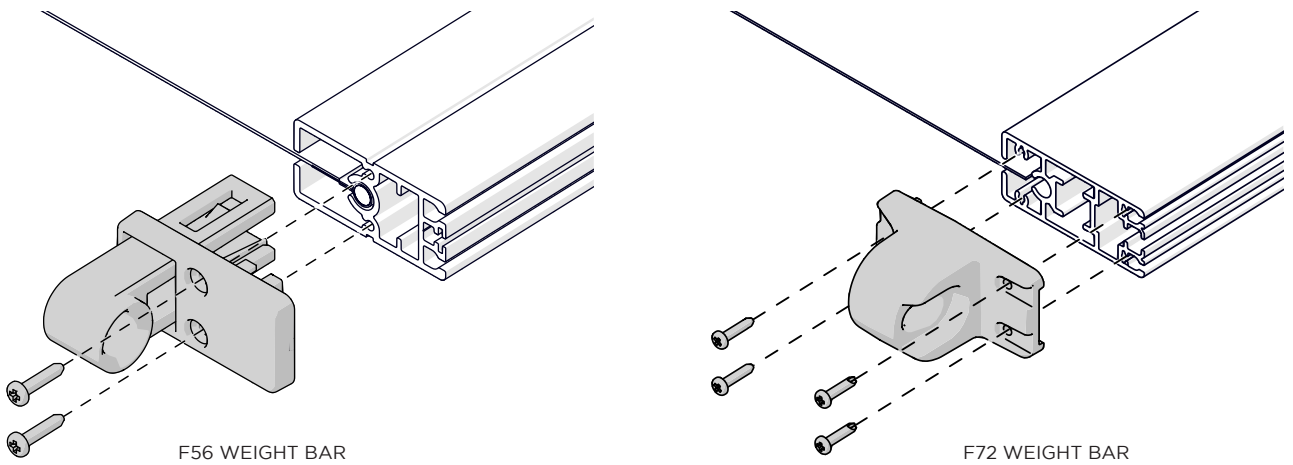

## WEIGHT BAR ASSEMBLY

## 3 Insert ballast (if required)

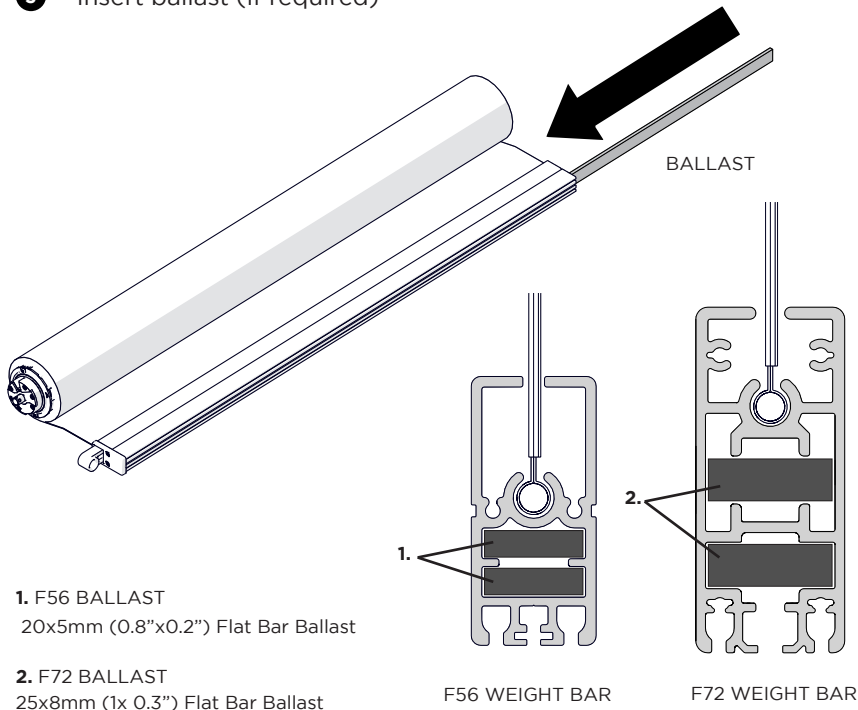
 **NOTE**

- Ballast is recommended in all motorized and crank control shades.
- If the ballast has been cut to size, use a Zinc-rich primer to protect the cut edges from corrosion.
- If using ballast on shades wider than 4m, only put the ballast on the outside edges.
- Max 2x lengths per ballast opening, total maximum of 4x lengths per weight bar.
- Extra ballast in the centre will create additional tube deflection.

## 4 Attach end caps

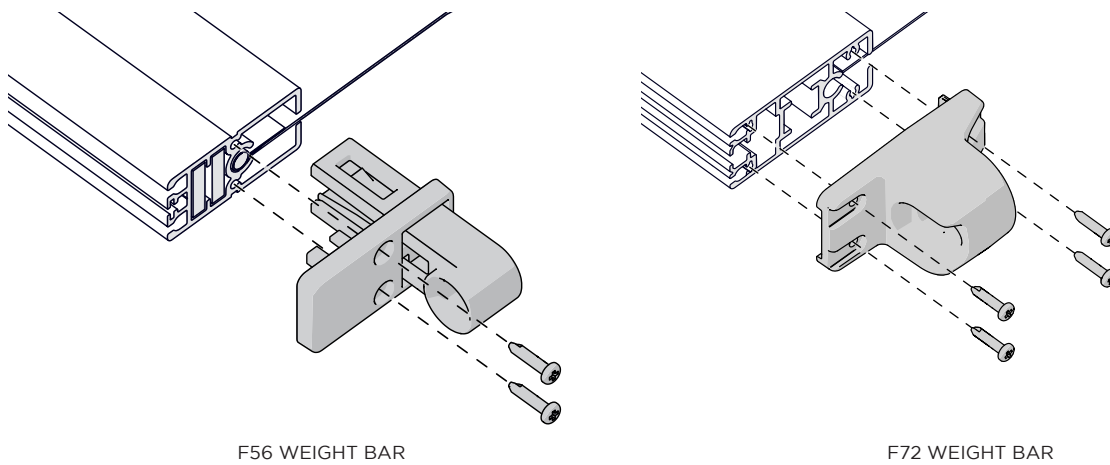

## PREPARE & PACK FOR TRANSPORTATION

Note: Images shown below are indicative only and will vary with system requirements.

Box 120  
Box 160  
Box 190

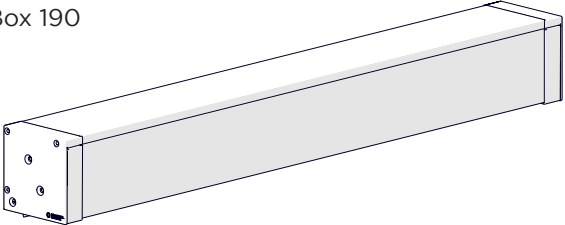

Open Brackets

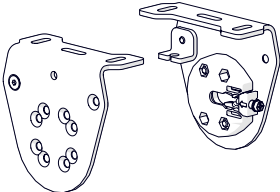

OR

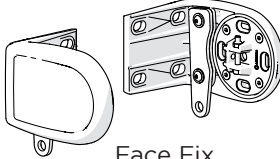

Face Fix

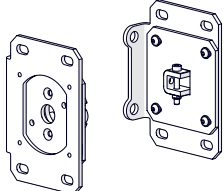

Recess Fix

**NOTE**

Store idler/spring adapter retaining clip until required (can be left in adaptor as shown)

Wire Guide and Fixing Hardware

**3.2mm Hardware**

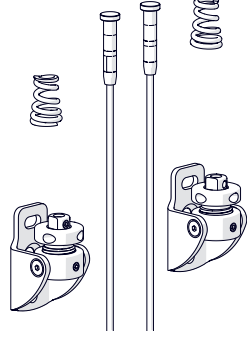

**4mm Hardware**

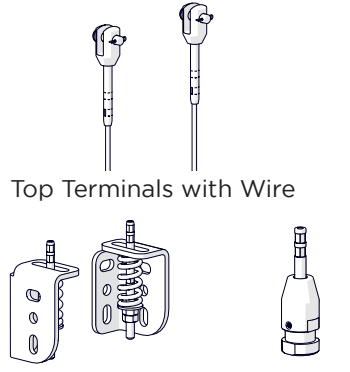

Top Terminals with Wire

Side/Face Fix
Floor Fix

Blind

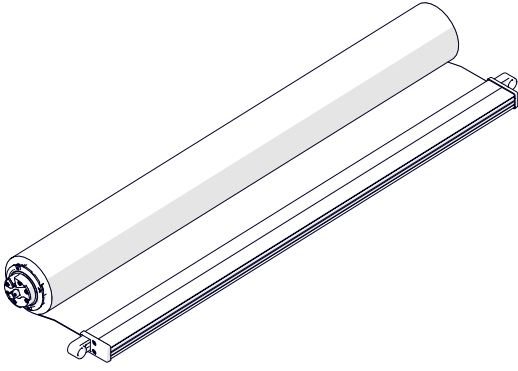

WIRE DEDUCTIONS

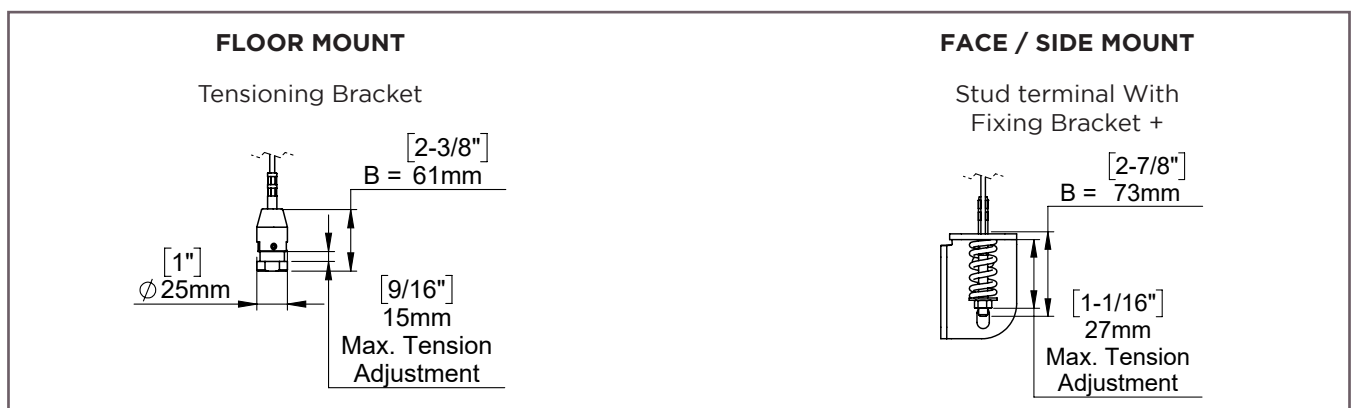
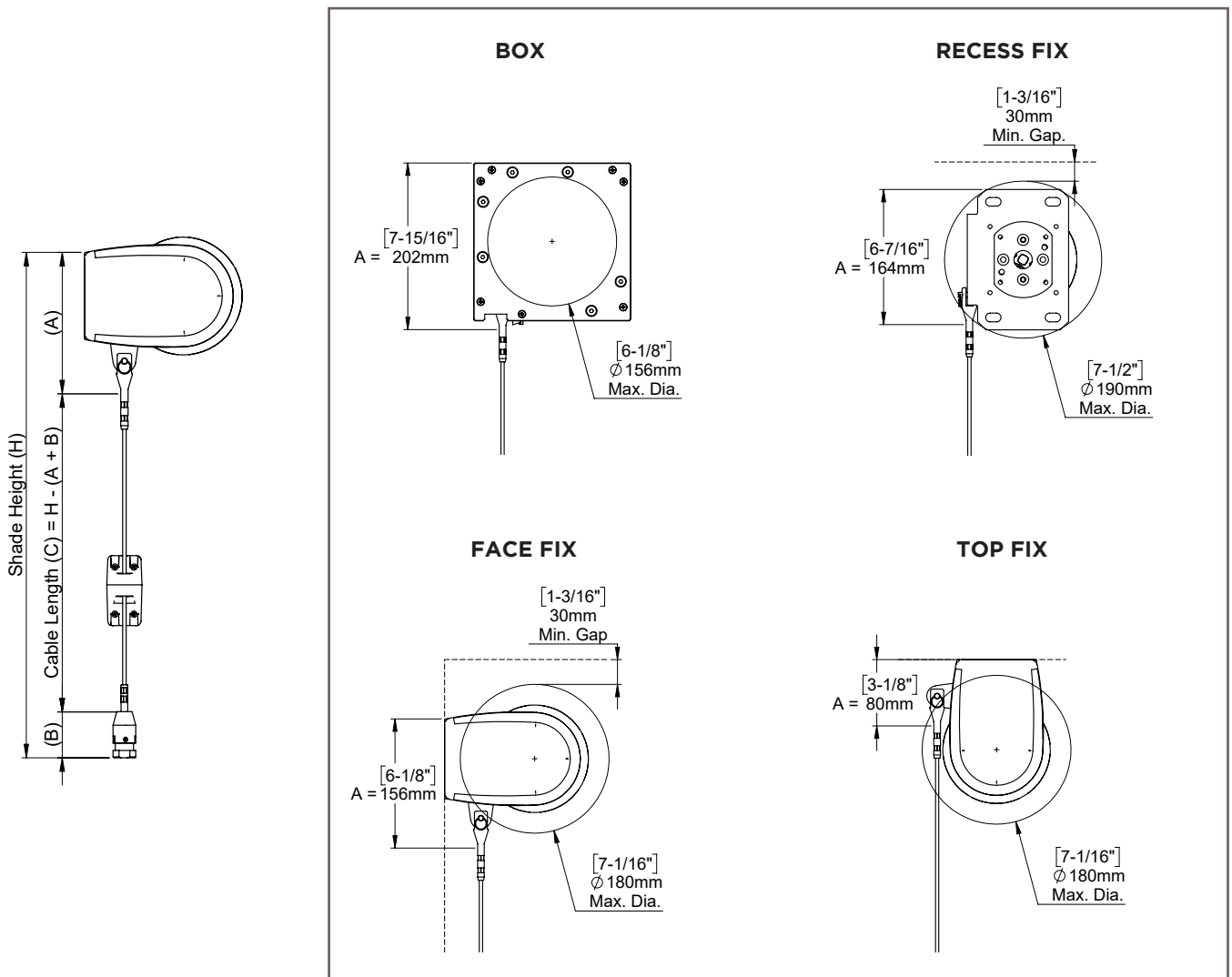

	CABLE LENGTH (C) = Height - (A + B)			
	<b>BOX 190</b>	<b>RECESS FIX</b>	<b>FACE FIX</b>	<b>TOP FIX</b>
<b>FLOOR MOUNT</b>	263mm	225mm	217mm	141mm
<b>FACE / SIDE MOUNT</b>	275mm	237mm	229mm	153mm

## SECTION G | DOCUMENT CHANGE NOTES

REVISION	CHANGES
v3.0   September 2023	Updated codes and items for Top Hardware Upgrade changes. Combined Wire Guide & Wire Guide Extreme information. 78mm Tube deduction changed to W - 68mm (+5mm, was W - 63mm).
v3.1   October 2024	Added Box 160 hardware.
v3.2   December 2024	Added step to drill wire guide terminals in Box 120 & Box 160.
v3.3   January 2025	Updated BOM (US Only). Removed white string reference from Box 160.