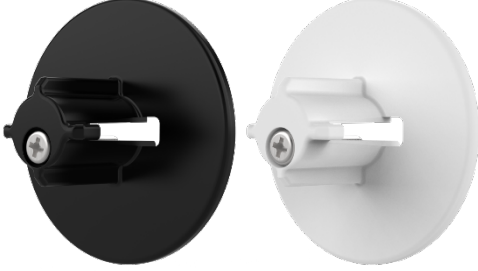

# NEW PRODUCT | HEAVY DUTY BRACKET ADAPTOR

PRODUCT DETAILS	
DESCRIPTION.	Medium HD Bracket Adaptor + Screw
CODE.	RB09-0701-050012 (Black)   RB09-0701-069012 (White)
PACK SIZE.	25 Sets
PRICE.	Refer to catalog
IMAGE.	
USE WITH.	Single & Dual Brackets with 12mm tongue, RB09 Chain Winders, 3Nm & 6Nm motors
AVAILABLE.	In stock now

## FUNCTIONAL BENEFITS

- 3Nm and 6Nm motors are now compatible with all RB Double Bracket solutions
  - Requires the motors to use the latest disc adaptors (refer associated PCL's)
- Robust solution for chain winders in commercial applications
  - Designed to protect the 12mm bracket tongue against excessive chain operation force
- Can be retrofit to existing installations
  - Remove shade from bracket, install HD Bracket adaptor, re-install shade
  - Requires additional 1.5mm idler clearance

## PRODUCTION / INSTALLATION

- Must allow for additional 1.5mm deduction during fabrication
- Screw requires #1 Phillips head

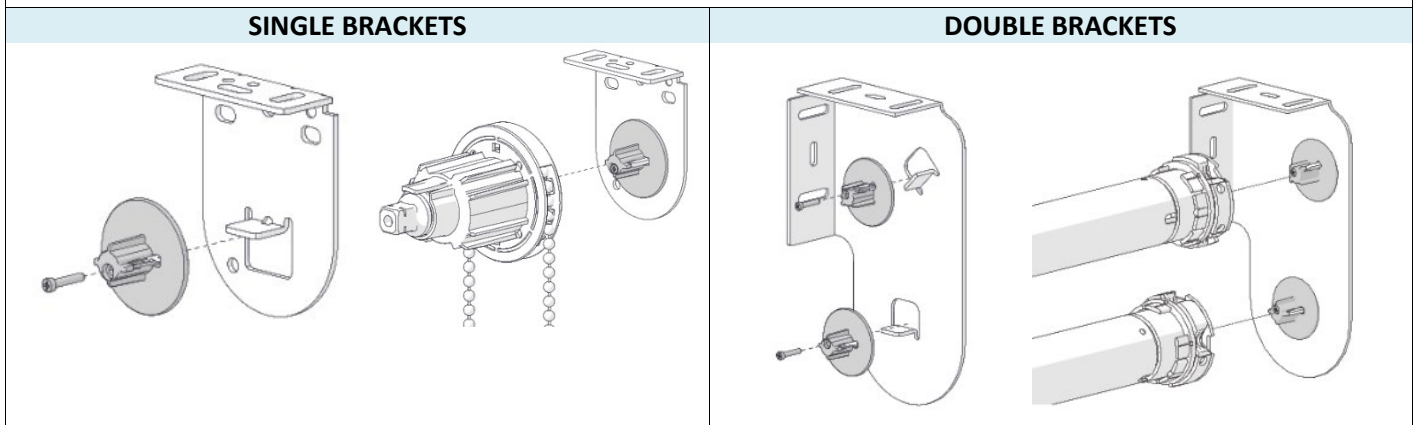

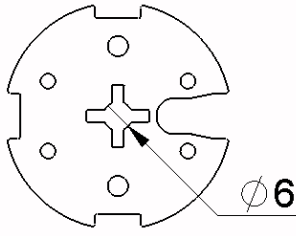
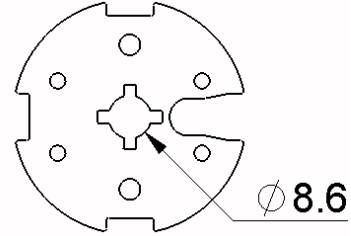
PRODUCT DETAILS		NO CHANGES MADE
DESCRIPTION.	M40 H/D Universal Disc Adaptor - S45	<input checked="" type="checkbox"/>
CODE.	RB40-1402-050400 (Black)   RB40-1402-069400 (White)	<input checked="" type="checkbox"/>
PACK SIZE.	5 pcs	<input checked="" type="checkbox"/>
PRICE.	\$2.12 each	<input checked="" type="checkbox"/>
IMAGE.	<b>PREVIOUS VERSION</b>	<b>NEW VERSION</b>
		
USE WITH.	All existing components, Heavy Duty Bracket Adaptor	
AVAILABLE.	In stock now	

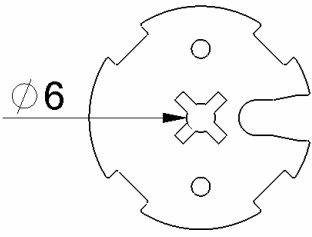
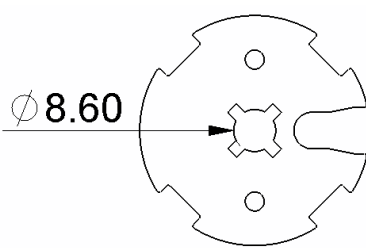
PRODUCT DETAILS		
DESCRIPTION.	M40 H/D SLIM Head ARC Motor Disc adptr S45	
CODE.	RB40-1402-069401 (White)	
PACK SIZE.	5 pcs	
PRICE.	\$8.23	
IMAGE.	<b>PREVIOUS VERSION</b>	<b>NEW VERSION</b>
		
USE WITH.	All existing components, RB Bracket Adaptor – Heavy Duty	
AVAILABLE.	In stock now	

- To provide motor compatibility with the Heavy Duty Bracket Adaptor (RB09-0701-xxx012)
- Instructions included in motor packaging pictured to the right.

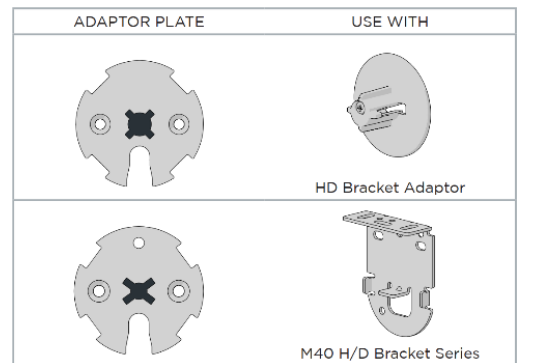
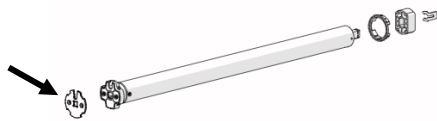

## PRODUCT CHANGES

- New disc adaptor is compatible with the HD Bracket Adaptor (RB09-0701-xxx012)
- Disc adaptor internal diameter increased to 8.6mm
- The use of the HD Bracket Adaptor will allow E6 & M6 motors to be installed on our range of single and double brackets.

