



# Curtain System

## **PRODUCT SPECIFICATIONS MANUAL**

v3.1 | March 2024



**ROLLEASE  
ACMEDA**  
PRECISION IN MOTION

# CONTENTS

<b>SECTION A   OVERVIEW</b>	01
GENERAL SCHEMATIC .....	01
<b>SECTION B   VERSA MOTOR SPECIFICATIONS</b>	02
<b>SECTION C   INSTALLATION SPECIFICATION</b>	03
TRACK PROFILE & DIMENSIONS .....	03
TOP/ CEILING FIX BRACKET .....	03
FACE FIX BRACKET .....	03
<b>SECTION D   DEDUCTIONS</b>	04
CENTRE DRAW .....	04
ONE WAY .....	04

## DISCLAIMER

### INTRODUCTION

This Product Specifications manual for CURTAIN SYSTEM has been produced by Rollease Acmeda to supply the necessary information for the safe and correct installation of CURTAIN SYSTEM.

### DISCLAIMER

Rollease Acmeda has used reasonable care in preparing the information included in this document, but makes no representations or warranties as to the completeness or accuracy of the information. Information is supplied upon the condition that the persons receiving the information will make their own determination as to its suitability for their purposes prior to use. Rollease Acmeda assumes no liability whatsoever for any damages incurred by you resulting from errors in or omissions from the information included herein. Rollease Acmeda reserves the right to make changes without further notice to any products to improve reliability, function or design.

### COPYRIGHT

COPYRIGHT © ROLLEASE ACMEDA

All rights are reserved. No part of this document may be reproduced or utilised in any means, by any means, electronic or mechanical including photocopying, recordings, or by any information storage or retrieval system, without the express permission from Rollease Acmeda.



GENERAL SCHEMATIC

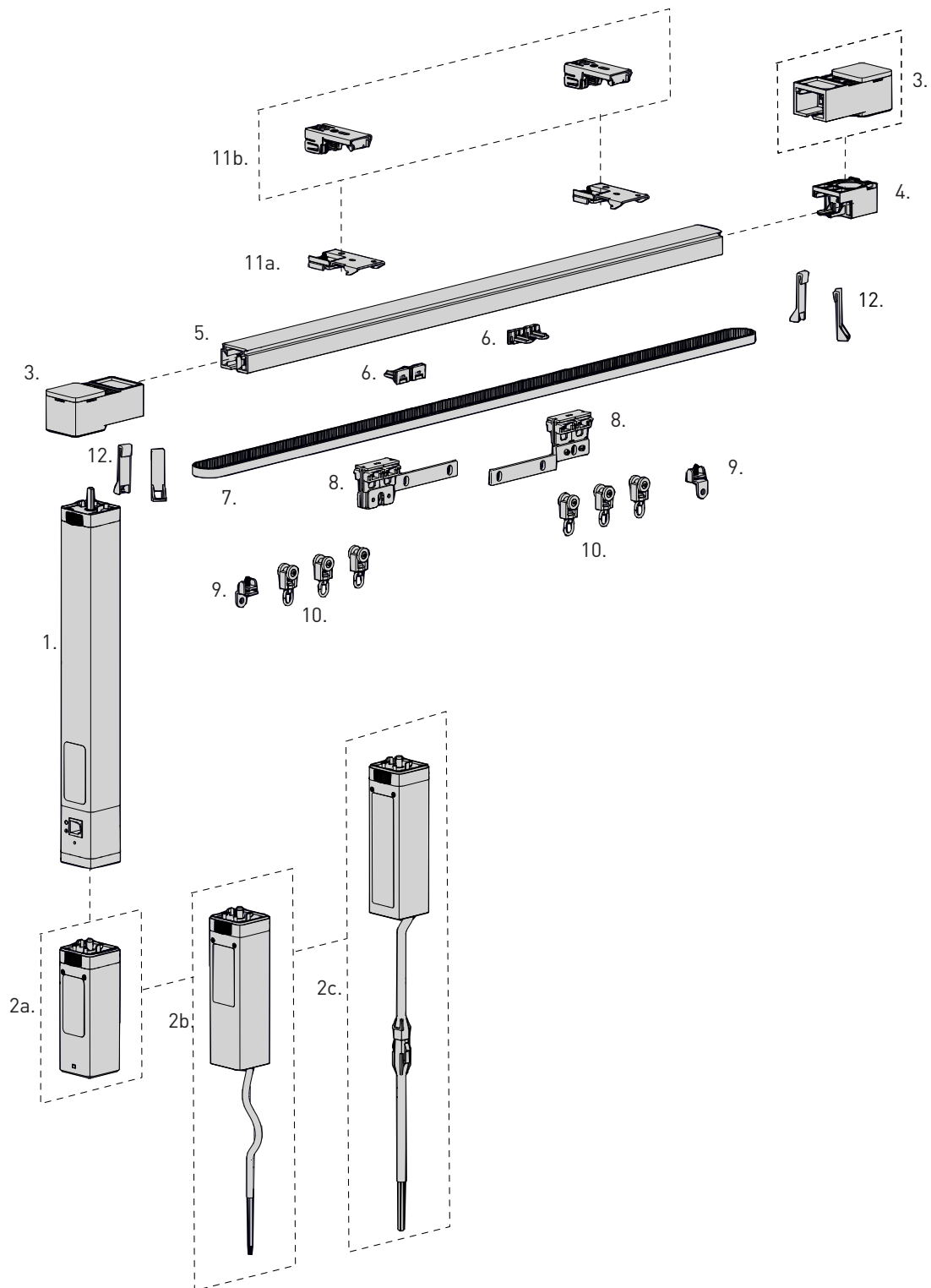

SYSTEM INDEX:

1. Versa Drapery Motor	4. Versa Return "S" Track Pulley	9. Stopper
2a. Versa Battery Module	5. Curtain Track	10. Runners
2b. Versa Module 6.1m [20'] Cord (120V) - US ONLY	6. Belt Fastening Buttons	11. Ceiling Bracket
2c. Versa Module 2.5m [8.2'] Cord (240V) - AU ONLY	7. Rubber Belt	12. End Hook
3. Versa Motor End "S" Track Pulley	8. Master Carrier	

## SECTION B | VERSA MOTOR SPECIFICATIONS

VERSA DRAPERY MOTOR SPECIFICATIONS					
Code	MT01-2101-xxx002	MT03-0305-xxx004	MT03-0305-069005	MT03-0305-069006	MT03-0305-xxx012
Description	Versa Drapery Motor	Battery Module	AC Module 10' Cord + Plug	AC Module 20' Cord	AC Module 2.5m Cord
Region	AU / EU / US	AU / EU / US	US	US	AU
Power Cable Length	-		3m [ 10' ]	6.1m [ 20' ]	2.5m [ 8.2' ]
Voltage Output	-	14.4V DC	18.0V DC		
Voltage Input	15V DC	-	120V AC 60 Hz		240V AC 50Hz
Capacity	-	2.55 Ah	-		
Running Time	12 min	-	-		
Current	1.3 A	-	2.0 A		
Power	20.0 W	-	36.0 W		
Stored Energy	-	36.72 Wh	-		
Charge Voltage	-	5V DC (Micro USB)	-		
Protection Class	IP20				
Torque	1.2 Nm	-			
Speed	80   100   120	-			
Frequency	433.925 MHz *	-			
Sound Level	44 dB	-			
Weight	0.83 Kg	0.27 Kg	0.32 Kg	0.49 Kg	0.30 Kg
	1.83 lbs	0.60 lbs	0.71 lbs	1.08 lbs	0.66 lbs
RF Protocol	ARC	-			
RF Modulation	FSK	-			
RF Signal Range	15m [ 49 ft ]	-			
Limit Switch Type	Electronic	-			
Temperature Range	-10 - 50 °C	0 - 45 °C	-10 - 50 °C		
	14 - 122 °F	32 - 113 °F	14 - 122 °F		
Limit Range	∞	-			
Insulation Class	Class A				
Life Cycle Testing	10,000 Cycles   50 Kg   Upto 11m Track				
Charge Time	-	8 hrs @ 2A	-		
Solar Panel Gen2	-	5V USB Compatible	-		
<p><b>Notes</b></p> <p>* Maximum transmitted power 10 mW</p> <p>Motor/Battery protection activates when battery voltage reaches 13.5V DC (motor stops when battery is flat)</p> <p>120 RPM is Default speed in operation ( 80 RPM is default speed during limit setting )</p> <p>Charge time is based on typical 5V / 2A charge rate of fully discharged battery, actual time may vary between batteries</p>					

TRACK PROFILE & DIMENSIONS

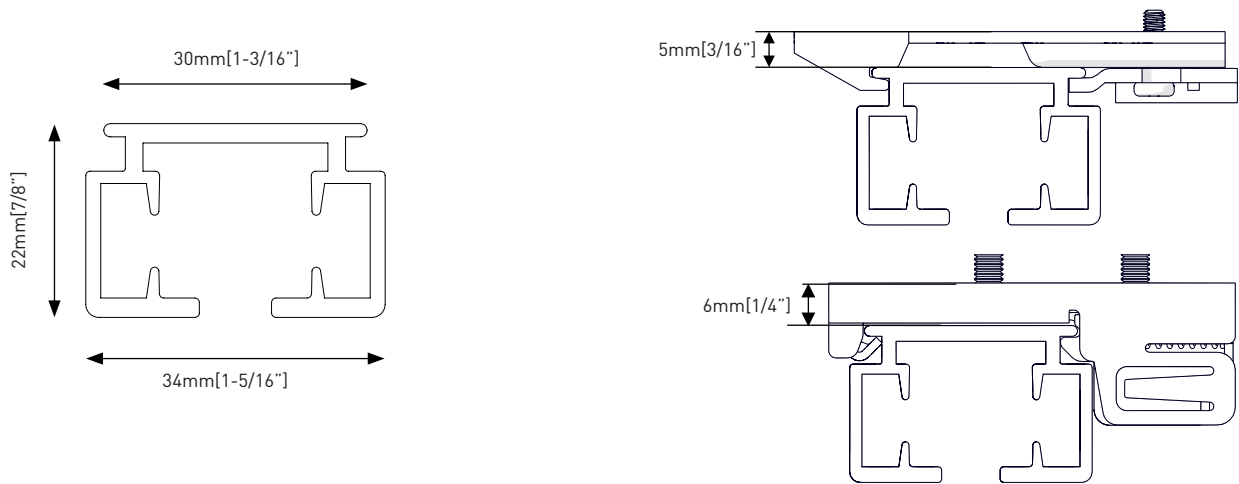

TOP/ CEILING FIX BRACKET

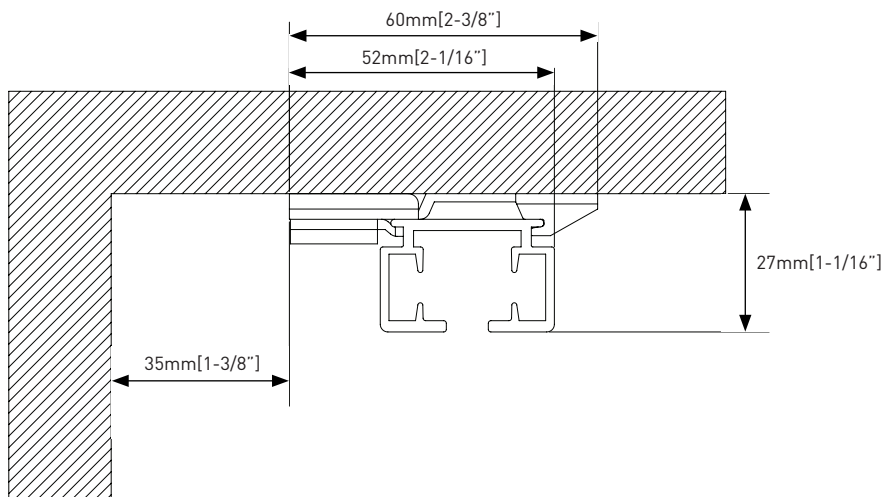

FACE FIX BRACKET

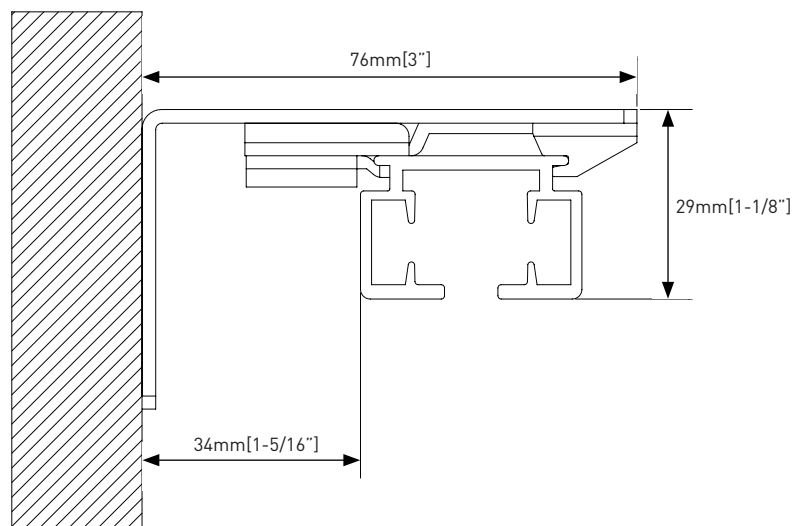

## SECTION D | DEDUCTIONS

### CENTRE DRAW

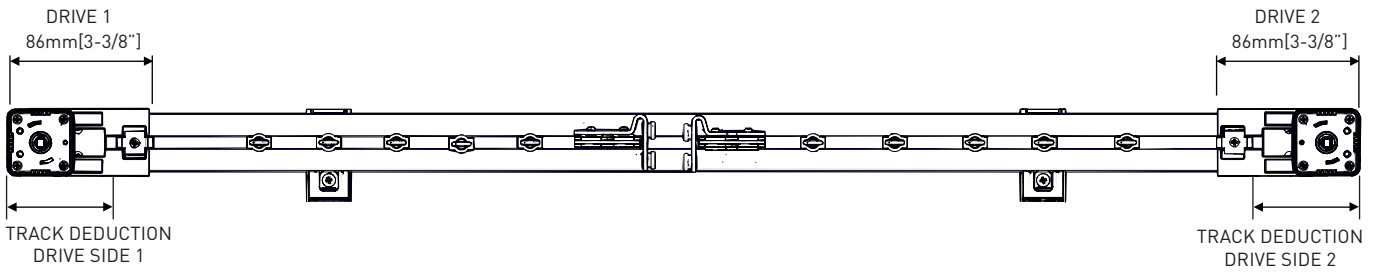

TRACK DEDUCTION				
CURTAIN TYPE	PULLEY TYPES	DRIVE SIDE 1	DRIVE SIDE 2	OVERALL DEDUCTION
CENTRE DRAW	DRIVE + DRIVE	59mm[2-5/16"]	59mm[2-5/16"]	118mm[4-5/8"]

### ONE WAY

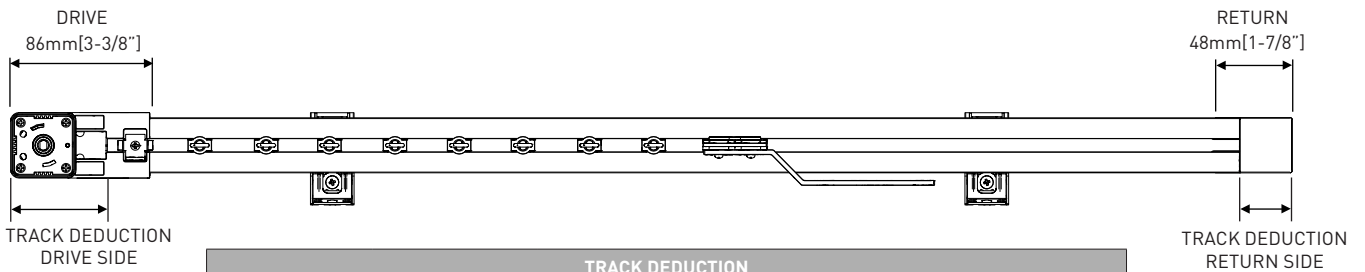

TRACK DEDUCTION				
CURTAIN TYPE	PULLEY TYPES	DRIVE SIDE	RETURN SIDE	OVERALL DEDUCTION
ONE WAY	DRIVE + RETURN	59mm[2-5/16"]	33mm[1-5/16"]	92mm[3-5/8"]